

ELEVATION

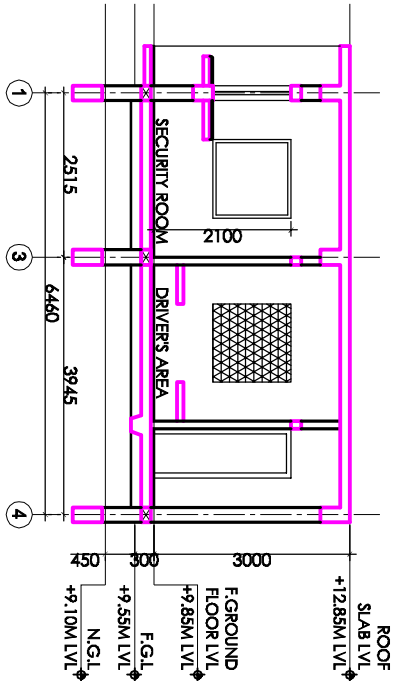

SECTION - AA'

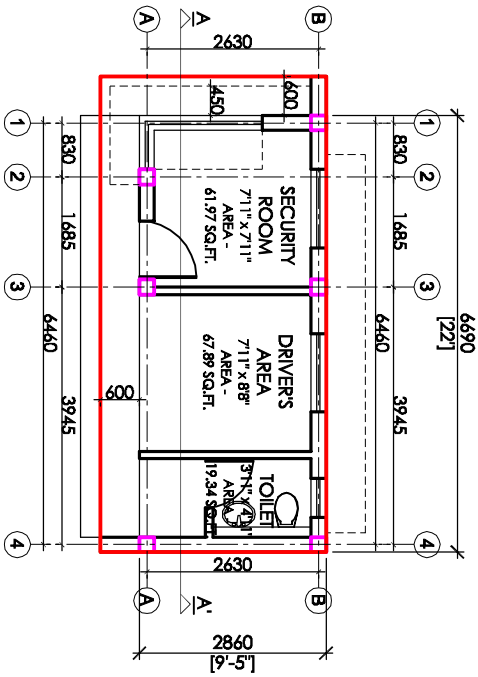

PLAN

- NOTES
1. This drawing is sole property of PitHAVADIAN and Partners and must not be used for any other project without the written consent of PitHAVADIAN and Partners.
 2. Any discrepancy in this drawing should be brought to the immediate attention of the Architect.
 3. All dimensions in millimeters and levels in meters.
 4. Dimensions to be followed as indicated and not to be made.

REV.	DATE	DESCRIPTION	DRAWN	CHEK.
REVISIONS				
AS BUILT				
CONSTRUCTION				
INFORMATION				
TENDER				
SCHEME				
SIBS FOR				

NAME OF THE PROJECT:
 TENDER

PROPOSED CONSTRUCTION OF INSTITUTIONAL BUILDING FOR
 M/S. ICAL, Chengalpattu District Branch of SIRC of ICAL

CLIENT:
 M/S. INSTITUTE OF CHARTERED ACCOUNTANTS OF INDIA
 Chengalpattu District Branch of SIRC of ICAL

DRAWING TITLE			
SECURITY & DRIVER'S RESTROOM			
PLAN, ELEVATION & SECTION			
STRUCTURAL CONSULTANT:			
ZACHARIA GEORGE FILE			
SCALE:	DESIGN BY:	DRAWN BY:	CHECKED BY:
1/25 @ A3	PDG	PAJIBIT	CNNHKA
DATE:	SIGN:	SIGN:	SIGN:
01.12.2022			

ARCHITECTURE * INTERIORS * PLANNING * ENGINEERING * MANAGEMENT

PITHAVADIAN AND PARTNERS

Chemel * Bangalore * Kochi * Hyderabad
 18, MULLEKAVAY, ROAD, NAVVA GARDENS,
 KOTTURBIDAK, CHENNAI - 600188
 Phone : +91 80 415447 0888/0713 0777
 Fax : +91 80 415447 0888/0713 0777
 Email : info@pavpartners.com
 Website : www.pavpartners.com

DWG NO: -4301-01-AR-06 [SHT 1 OF 01] REV NO: -